

PLUG IN TYPE TERMINAL BLOCK — ETB87 SERIES

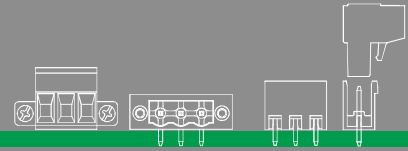

SOCKET TYPE

PITCH=3.5mm

■ FEATURES

- Special wire protector design to ensure reliable wire clamping
- Be capable of clamping a wide range of wire diameters
- The Male connector of plug using a twin leaf phosphor bronze contact mates with the Female socket
- The Female socket is mounted and soldered to the P.C.B.
- Good for insertion & withdrawal
- UL 94V-0 grade fire retardant engineering plastic used for the housing

■ SPECIFICATIONS

- Pitch 3.50 mm
- No. of pole per block 2P to 16P
- Rating 6 Amp, 300 VAC
- Housing PA66
- Terminals Tin plated over Copper Alloy
- Operating temperature -30°C ~ +110°C
(Includes temperature rise limit)
- UL Approval 300V, 6A
- TUV Approval 130V, -30°C ~ +110°C, 8A Max.,
0.2~1.0mm²

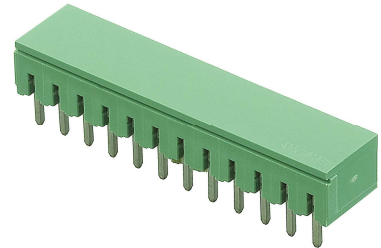

■ PART NUMBERING SYSTEM

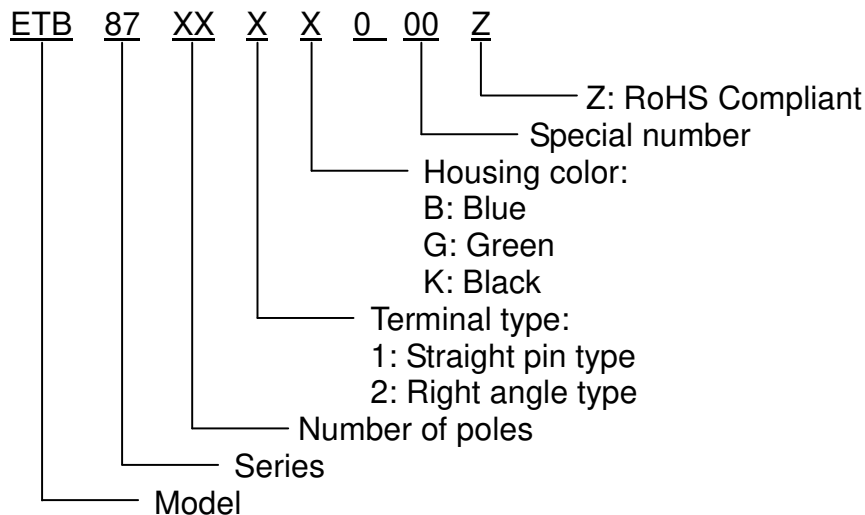

PLUG IN TYPE TERMINAL BLOCK — ETB87 SERIES

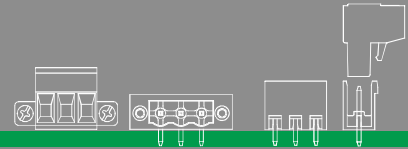

DRAWING

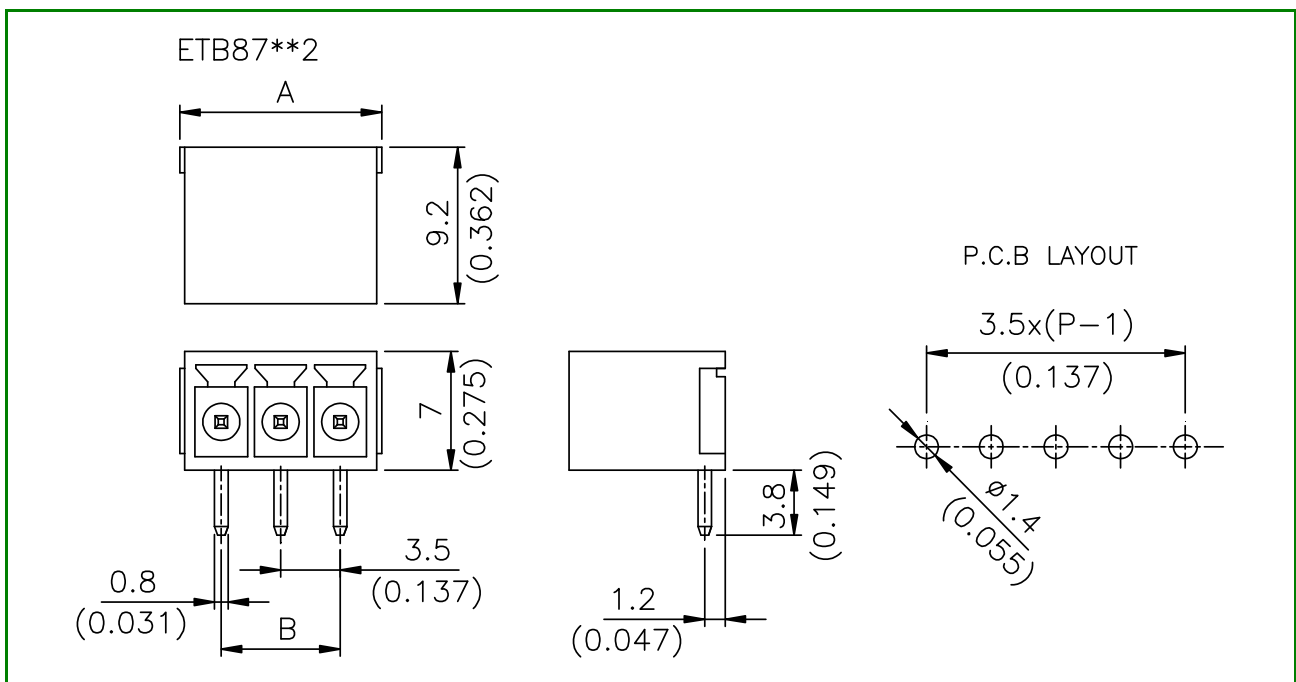
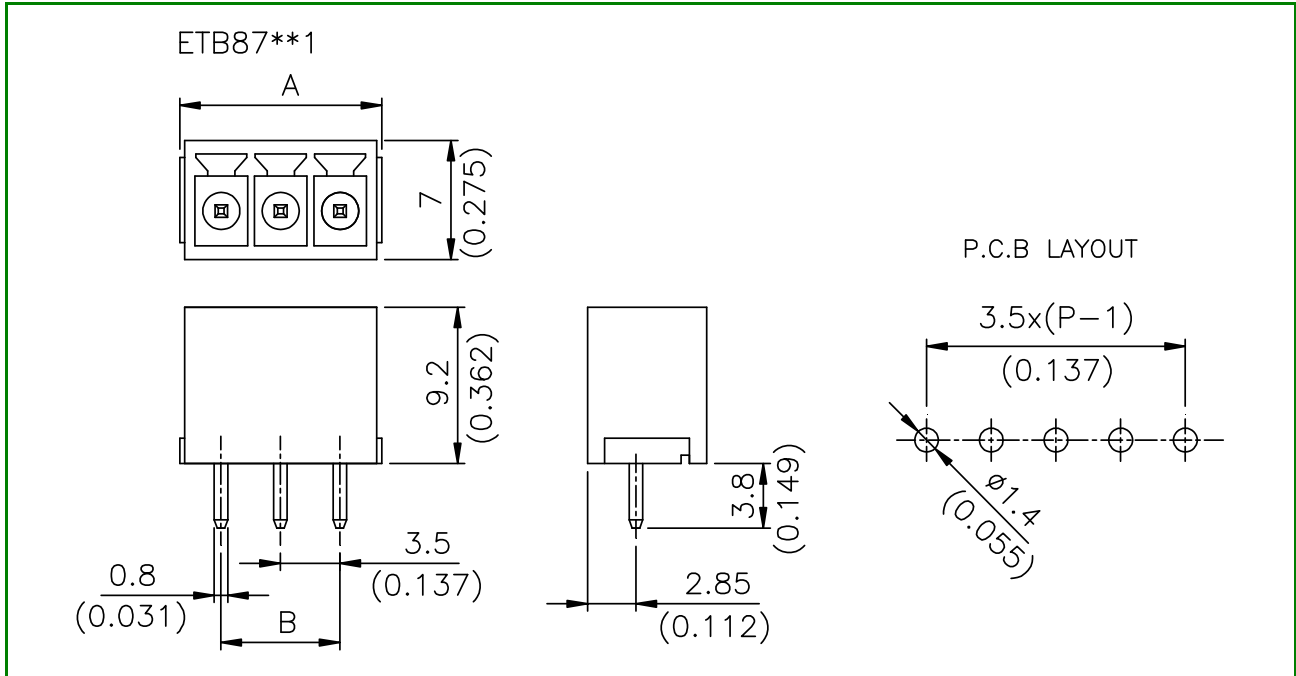

| POLE DIM. | 2 | 3 | 4 | 5 | 6 | 7 | 8 | 9 | 10 | 11 | 12 | 13 | 14 | 15 | 16 |
|--------------|----------------|-----------------|-----------------|-----------------|-----------------|-----------------|-----------------|-----------------|-----------------|-----------------|-----------------|-----------------|-----------------|-----------------|-----------------|
| A | 8.4 (0.331) | 11.9 (0.469) | 15.4 (0.606) | 18.9 (0.744) | 22.4 (0.882) | 25.9 (1.020) | 29.4 (1.157) | 32.9 (1.295) | 36.4 (1.433) | 39.9 (1.571) | 43.4 (1.709) | 46.9 (1.846) | 50.4 (1.984) | 53.9 (2.122) | 57.4 (2.260) |
| B | 3.5 (0.138) | 7.0 (0.276) | 10.5 (0.413) | 14.0 (0.551) | 17.5 (0.689) | 21.0 (0.827) | 24.5 (0.965) | 28.0 (1.102) | 31.5 (1.240) | 35.0 (1.378) | 38.5 (1.516) | 42.0 (1.654) | 45.5 (1.792) | 49.0 (1.929) | 52.5 (2.067) |